

# State of Wyoming Corner Record

(In compliance with the *CORNER PERPETUATION AND FILING ACT*, Wyoming Statutes, 1997 Section 33-29-140 et. seq., and the Rules and Regulations of the Board of Professional Engineers and Professional Land Surveyors)

Reverse side of this form may be used if more space is needed.

Record of original survey and citation of source of historical information (if corner is lost or obliterated). Description of corner monumentation evidence found and/or monument and accessories established to perpetuate the location of this corner. Sketch of relative location of monument, accessories, and reference points with course and distance to adjacent corner(s) (if determined in this survey). Method and rationale for reestablishment of lost or obliterated corner.

**FOUND:** 2 1/2" PLS 9063 BLANK ALUMINUM CAP NEAR SOUTHWEST CORNER OF SECTION 33 NO DETERMINATION MADE AS TO THE PERTUATION OF THE ORIGINAL CORNER POSITION

**SET:** NOTHING

**NOTE:**  
THIS CORNER RECORDATION FORM IS BEING FILED TO RECORD MONUMENTATION FOUND IN THE VICINITY OF THE CORNER IN QUESTION. FILING OF THIS FORM IS NOT INTENDED TO SUGGEST ACCEPTANCE OF THE MONUMENT AS PERPETUATING THE ORIGINAL CORNER LOCATION.

See attached photos - For additional information on this corner see map of survey for T12N R60W and a portion of T13N R60W on file at the Laramie County Clerk's Office in Survey Cabinet 4 Map 29

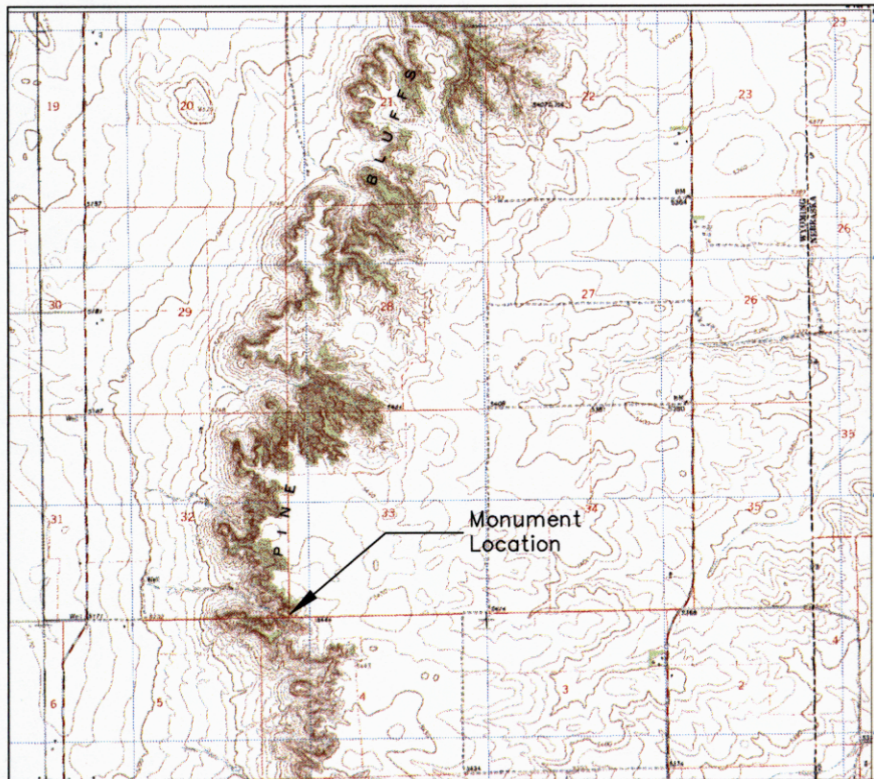

**Monument location**



**Monument Inscription**

Date of Field Work: 5/25/2007

Office Reference: 2655

### Cross Index Plat

|   |   |    |   |   |    |   |   |   |   |    |    |    |    |    |    |    |    |    |    |    |    |    |    |    |    |
|---|---|----|---|---|----|---|---|---|---|----|----|----|----|----|----|----|----|----|----|----|----|----|----|----|----|
|   | 1 | 2  | 3 | 4 | 5  | 6 | 7 | 8 | 9 | 10 | 11 | 12 | 13 | 14 | 15 | 16 | 17 | 18 | 19 | 20 | 21 | 22 | 23 | 24 | 25 |
| A | + | +  | + | + | +  | + | + | + | + | +  | +  | +  | +  | +  | +  | +  | +  | +  | +  | +  | +  | +  | +  | +  | +  |
| B | + | +  | + | + | +  | + | + | + | + | +  | +  | +  | +  | +  | +  | +  | +  | +  | +  | +  | +  | +  | +  | +  | +  |
| C | + | 6  | + | + | 5  | + | + | + | + | 4  | +  | +  | +  | +  | 3  | +  | +  | +  | +  | +  | 2  | +  | +  | +  | 1  |
| D | + | +  | + | + | +  | + | + | + | + | +  | +  | +  | +  | +  | +  | +  | +  | +  | +  | +  | +  | +  | +  | +  | +  |
| E | + | +  | + | + | +  | + | + | + | + | +  | +  | +  | +  | +  | +  | +  | +  | +  | +  | +  | +  | +  | +  | +  | +  |
| F | + | +  | + | + | +  | + | + | + | + | +  | +  | +  | +  | +  | +  | +  | +  | +  | +  | +  | +  | +  | +  | +  | +  |
| G | + | 7  | + | + | 8  | + | + | + | + | 9  | +  | +  | +  | +  | 10 | +  | +  | +  | +  | +  | 11 | +  | +  | +  | 12 |
| H | + | +  | + | + | +  | + | + | + | + | +  | +  | +  | +  | +  | +  | +  | +  | +  | +  | +  | +  | +  | +  | +  | +  |
| J | + | +  | + | + | +  | + | + | + | + | +  | +  | +  | +  | +  | +  | +  | +  | +  | +  | +  | +  | +  | +  | +  | +  |
| K | + | +  | + | + | +  | + | + | + | + | +  | +  | +  | +  | +  | +  | +  | +  | +  | +  | +  | +  | +  | +  | +  | +  |
| L | + | 18 | + | + | 17 | + | + | + | + | 16 | +  | +  | +  | +  | 15 | +  | +  | +  | +  | +  | 14 | +  | +  | +  | 13 |
| M | + | +  | + | + | +  | + | + | + | + | +  | +  | +  | +  | +  | +  | +  | +  | +  | +  | +  | +  | +  | +  | +  | +  |
| N | + | +  | + | + | +  | + | + | + | + | +  | +  | +  | +  | +  | +  | +  | +  | +  | +  | +  | +  | +  | +  | +  | +  |
| O | + | +  | + | + | +  | + | + | + | + | +  | +  | +  | +  | +  | +  | +  | +  | +  | +  | +  | +  | +  | +  | +  | +  |
| P | + | 19 | + | + | 20 | + | + | + | + | 21 | +  | +  | +  | +  | 22 | +  | +  | +  | +  | +  | 23 | +  | +  | +  | 24 |
| Q | + | +  | + | + | +  | + | + | + | + | +  | +  | +  | +  | +  | +  | +  | +  | +  | +  | +  | +  | +  | +  | +  | +  |
| R | + | +  | + | + | +  | + | + | + | + | +  | +  | +  | +  | +  | +  | +  | +  | +  | +  | +  | +  | +  | +  | +  | +  |
| S | + | +  | + | + | +  | + | + | + | + | +  | +  | +  | +  | +  | +  | +  | +  | +  | +  | +  | +  | +  | +  | +  | +  |
| T | + | 30 | + | + | 29 | + | + | + | + | 28 | +  | +  | +  | +  | 27 | +  | +  | +  | +  | +  | 26 | +  | +  | +  | 25 |
| U | + | +  | + | + | +  | + | + | + | + | +  | +  | +  | +  | +  | +  | +  | +  | +  | +  | +  | +  | +  | +  | +  | +  |
| V | + | +  | + | + | +  | + | + | + | + | +  | +  | +  | +  | +  | +  | +  | +  | +  | +  | +  | +  | +  | +  | +  | +  |
| W | + | +  | + | + | +  | + | + | + | + | +  | +  | +  | +  | +  | +  | +  | +  | +  | +  | +  | +  | +  | +  | +  | +  |
| X | + | 31 | + | + | 32 | + | + | + | + | 33 | +  | +  | +  | +  | 34 | +  | +  | +  | +  | +  | 35 | +  | +  | +  | 36 |
| Y | + | +  | + | + | +  | + | + | + | + | +  | +  | +  | +  | +  | +  | +  | +  | +  | +  | +  | +  | +  | +  | +  | +  |
| Z | + | +  | + | + | +  | + | + | + | + | +  | +  | +  | +  | +  | +  | +  | +  | +  | +  | +  | +  | +  | +  | +  | +  |

Firm/Agency, Address

AVI P.C.  
2035 WESTLAND RD.  
CHEYENNE, WY. 82001

This corner record was prepared by me or under my direct and supervision.

SEAL & SIGNATURE

Telephone Number: 307-637-6017

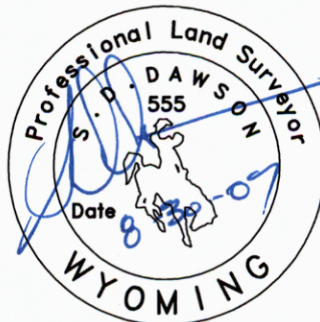

Corner Name SE Section 32, T 13 N, R 60 W, 6TH P.M.

Cross-Index No.: Z-9

County: LARAMIE Wyoming

SBRPEPLS/PLSW: March 1994; PLSW January 1998

RECORDED 3/19/2008 AT 4:26 PM REC# 495886 X# 2050 PG# 1615  
 DEBRA K. LATHROP, CLERK OF LARAMIE COUNTY, WY PAGE 1 OF 3





Corner Name SE Section 32, T 13 N, R 60 W, 6TH P.M.

RECORDED 3/19/2008 AT 4:26 PM REC# 495886 3K# 2050 PG# 1616  
DEBRA K. LATHROP, CLERK OF LARAMIE COUNTY, WY PAGE 2 OF 3





Corner Name SE Section 32, T 13 N, R 60 W, 6TH P.M.

RECORDED 3/19/2008 AT 4:26 PM REC# 495886 BK# 2050 PG# 1617  
DEBRA K. LATHROP, CLERK OF LARAMIE COUNTY, WY PAGE 3 OF 3